

LED SPOT LIGHT INSTRUCTION SHEET

IMPORTANT: Please read all instructions before installing fixture. Retain for future reference.

CAUTION: This fixture is for New Construction and Remodel applications. For your safety, this fixture must be wired in accordance with local electrical codes and ordinances. All work must be done by a certified electrician.

WARNING: Risk of electric shock, do not use where directly exposed to water and make sure power is OFF from electrical panel before starting installation or attempting any maintenance.

TOOL REQUIRED: Screw driver, insulated pliers, hole saw, ladder, pencil, wire stripper and tape measure.

PRE-INSTALLATION:

1: TURN Power OFF from the electric panel before start wiring.

2: New construction applications: Install the suitable mounting plate accordance with the fixture cutout size. Mounting plate sold separately.

Remodel applications: Locate a suitable position to plate the fixture, Measure distance from the wall and mark it on the paper, make sure marked point is between joists.

3: Run electrical cable through in the ceiling space from the switch (power supply). Make sure supply wire insulation must be rated for at least 90°C (NMD90 Romex or AC90 BX cable).

CUTOUT TABLE:

Product Code	Cutout	Ceiling Cover Thickness
Round trim	φ75mm (3")	5-25mm (7/16"-1")
Round trimless	φ75mm (3")	
Square trim	φ 75*75mm (3" *3")	
Square trimless	φ 75*75mm (3" *3")	

FIXTURE INSTALLATION (TRIM FOR DRYWALL OR T-BAR CEILING)

1.Installation

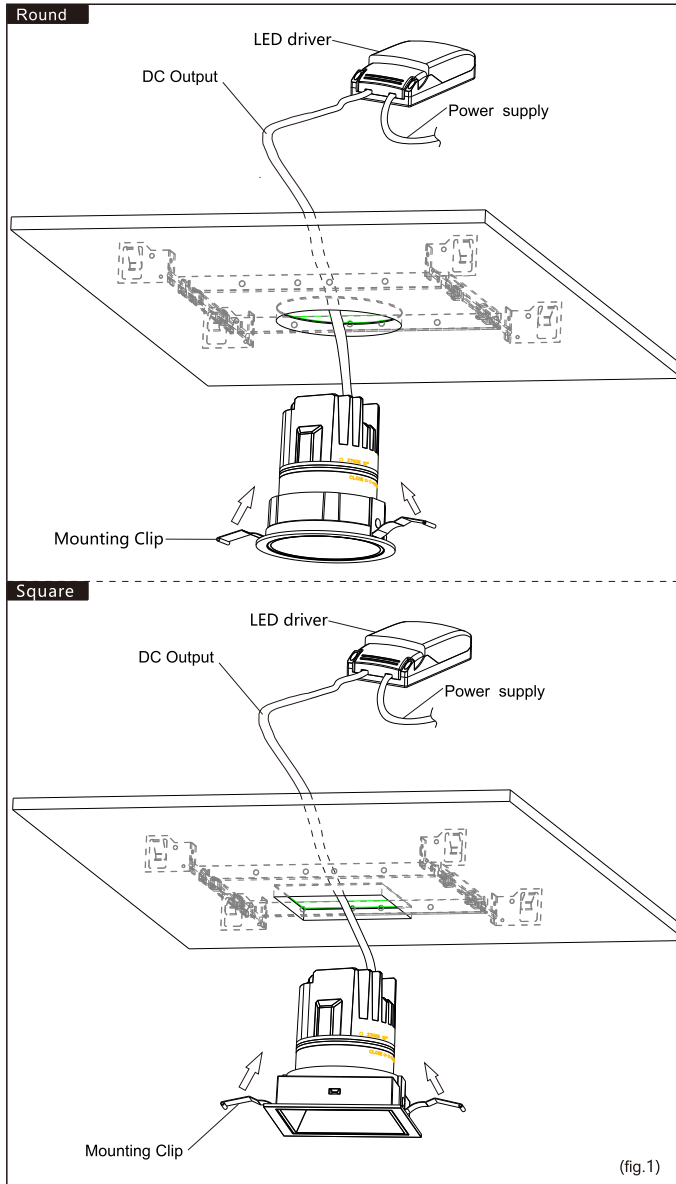

2.Accessories Installation (fig.2)

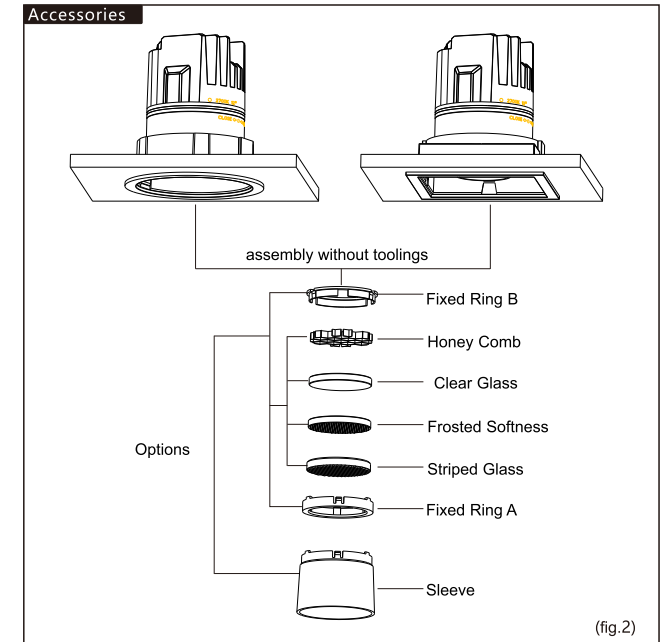

3. Secondary Reflector Installation (fig.3)

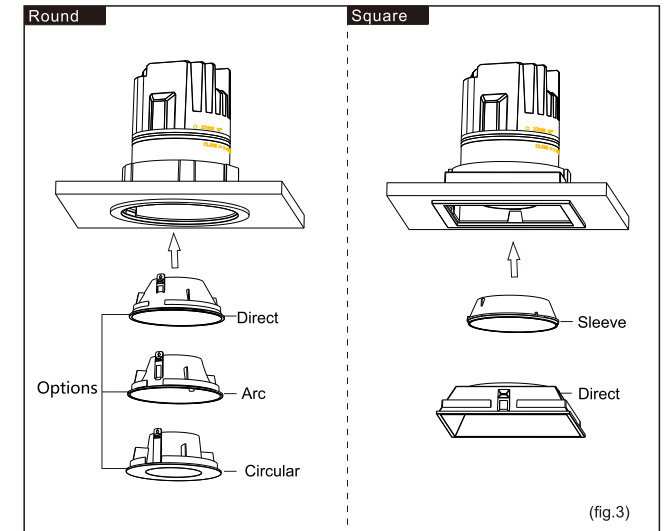

4. For adjustable fixture , adjust to a proper direction of illumination before assembling the reflector (fig.4)

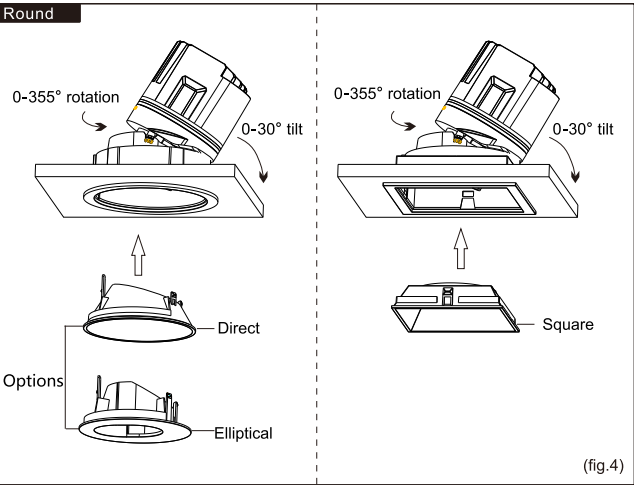

**FIXTURE INSTALLATION
(TRIMLESS FOR DRYWALL CEILING ONLY)**

1.Trimless Bezel Installation

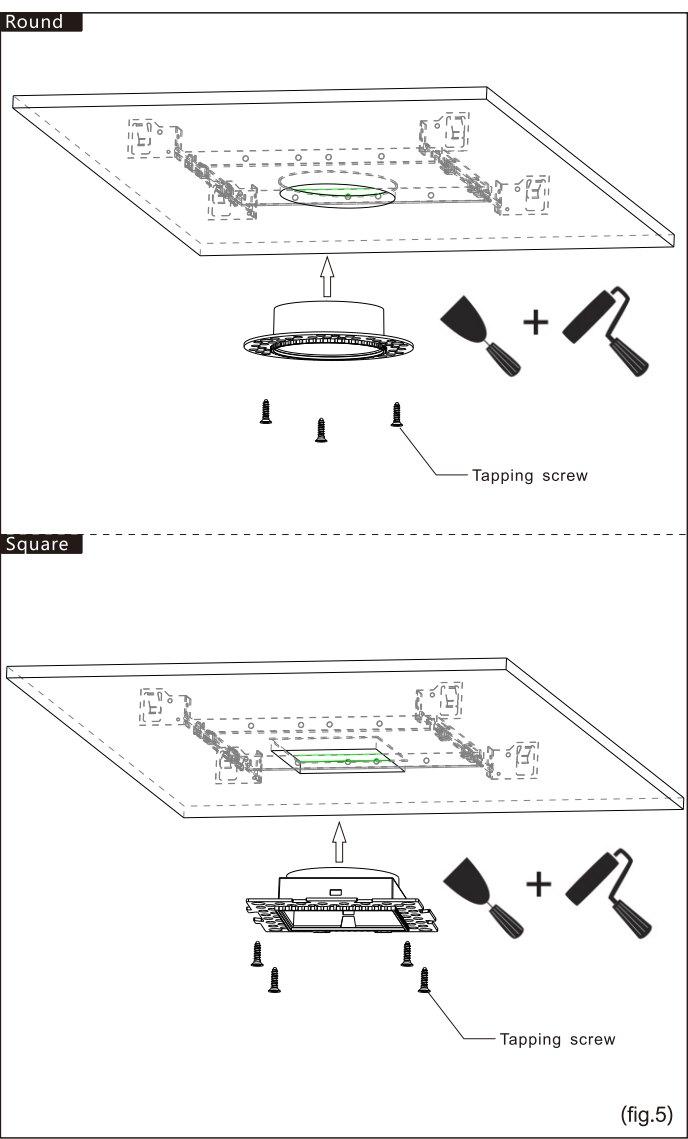

2.Fixture Installation

