

BOURG-Q

8W -12W Dia 118 mm

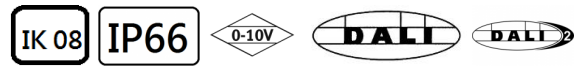

BOURG LED BOLLARDS LIGHT is an innovative bollard light which enhances the aesthetic and creative of city in IP66, its architectural design can meet the demands of different areas in squares, parks, gardens, sidewalks and others.

- Unique and gorgeous appearance.
- IP66 and IK08
- High transparent Anti-UV PC diffuser, it can effectively prevent yellowing and aging.
- 0.5m and 0.8m height optional.
- Surface anti-ultraviolet pure polyester powder painting for corrosion resistance

BOURG-Q

8W -12W Dia 118 mm

Technical Data

Luminaire Type-安裝方式 Tipo de luminaria	• Expansion Bolt Mounting 膨脹螺栓安裝 Montaje de perno de expansión		
Dimension-尺寸-Dimensión	Dia 118x500mm	/	Dia 118x900mm
Luminaire Net Weight 燈具淨重 Peso neto de la luminaria	2.2±0.3kg	/	2.8±0.3kg
Power Consumption Max-燈具功率 Consumo de energía Max	<ul style="list-style-type: none"> • 8W • 10W • 12W 		
Input Voltage-輸入電壓-Voltaje de entrada	AC 220-240V 50/60Hz		
LED Driver Type LED驅動款式 Tipo de controlador LED	Integrated-type LED Driver--Refer to LED driver specification 請參閱LED驅動器規格 Consulte la especificación de controlador de LED 1. ON/OFF Switch 2. 1-10V Dimming 1-10% Driver 3. Dali Dimming 1-10% Driver		
LED Driver Features驅動特性 Funciones del controlador de LED	POWER FACTOR : PF>0.90 or PF:>0.95 TOTAL HARMONIC DISTORTION: THD< 20% Refer to LED Driver for Detail		
Control Protocol-控制協議 Protocolo de Control	1-10V / Dali 1 / Dali 2		
Beam Angle光束角ángulo de haz	Symmetric Angle 對稱角度 Ángulo simétrico		
Light Source Brand-光源品牌-Fuente de luz de marca	CREE - (Photobiological safety-IEC 62471 'Risk Group 1' (low risk))		
"Lumen Maintenance LM-80 Reported by TM-21"	L70 > 45,000 hrs		
LED Life-LED壽命-La vida del LED	>60,000 hours		
Color Temperature -色溫 Temperatura del color	2700K / 3000K / 4000K / 5000K / 6500K		
Color Rendering Index-顯色指數 Índice de reproducción cromática	>80 >90		
MacAdam Ellipses Binning 麥克亞當橢圓分級 Mac Adam binning ellipse	Standard Deviation Colour Matching < 3 SDCM 標準偏差配色 < 3 SDCM Coincidencia de color estándar Desviación < 3 SDCM		
Luminaire Efficacy燈具效率La eficacia de la luminaria	60Lm/w(2700K), 60 Lm/w(3000K), 70 Lm/w(4000K), 80 Lm/w(5000K), 70 Lm/w(6500K),		
LED Source Luminous Efficacy LED光源光效 Fuente luminosa LED Eficacia	140Lm/w(2700K), 140 Lm/w(3000K), 150Lm/w(4000K), 160 Lm/w(5000K), 160 Lm/w(6500K),		
Housing materials-外殼材料 Materiales de la carcasa	Type A: Aluminum Alloy and Anti UV Opal Polycarbonate Diffuser 鋁合金和抗紫外線乳白PC擴散器 ifusor de aleación de aluminio y policarbonato opal anti UV Type B: Aluminum Alloy , Anti UV Polycarbonate reflector and Clear Diffuser 鋁合金, 抗紫外線PC反射器和透明PC擴散器 Aleación de aluminio, reflector de policarbonato anti UV y difusor transparente		
Housing Color 外殼顏色 color de la carcasa	Mechanical and chemical anti-corrosion pre-treatment UV-resistant polyester exterior powder-coating system. 機械和化學防腐預處理使用防紫外線粉末塗料體 Pretratamiento mecánico y químico anticorrosión. Sistema de recubrimiento en polvo exterior de poliéster resistente a los rayos UV. <ul style="list-style-type: none"> • Graphite 石墨黑 Grafito RAL 9005 • Gray 灰色 Gris RAL 9006 • White 白色 Blanco RAL9010 		
Ingress Protection-防護等級 Protección de ingreso	IP66		
Mech impact protection 機械衝擊保護 Protección contra impactos mecánicos	IK08		
Operating Temperature Range / 工作溫度範圍 Rango de temperatura de funcionamiento	-20 °C / +50 °C		
Operating Humidity -工作濕度 Humedad de funcionamiento	0~90%, non-condensing-不結霜 sin condensación		
Comply Testing Standard 符合測試標準 Cumplir el estándar de prueba	LED Luminaires: IEC 60598-1 / IEC 60598-2-1 LED Driver: IEC/EN 61347-1; IEC/EN 61347-2-13; IEC/EN 62384; IEC/EN 61000-3-2; IEC/EN 61000-3-3; IEC/EN 61574; EN 55015		

Certification-認證-Certificación



BEAM ANGLE

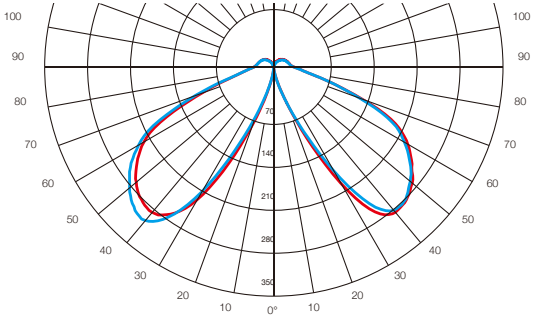

Type A

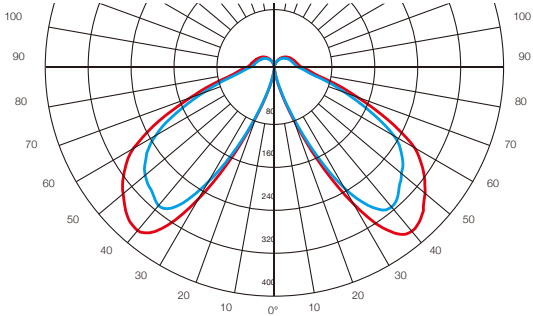

Type B

Technical Drawing

Type A

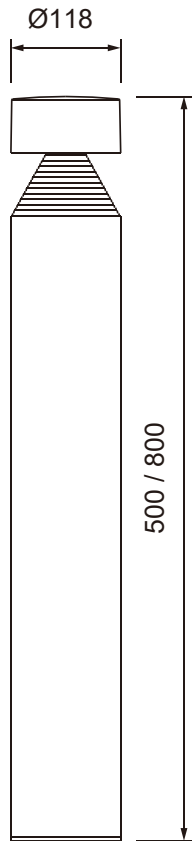

Type B with Clear Anti-UV PC diffuser

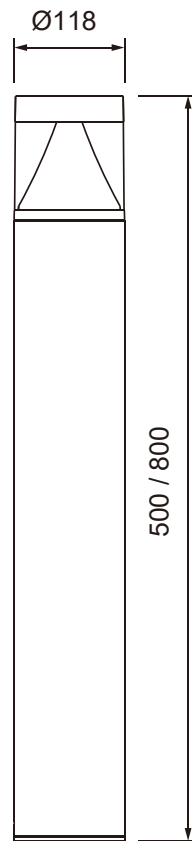

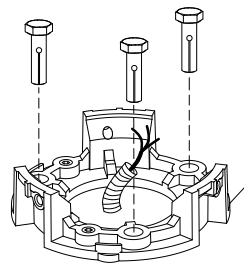
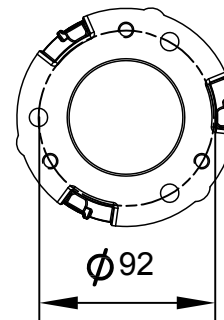

Installation Plate Detail



Optional : Flange Type



Accessories

	Code
 Terminal Box	DM230000232
 Anchor Bolts	DM250000376
 Expansion Bolts	DM613040005

Unit: mm

Installation Menu -BOUTH X

DIMON
TECHNOLOGY

