

DUMBER-24W

Max 24W IP20

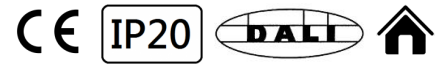

Accessories(Ø75)

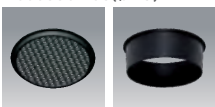

Honeycomb Snoot



LED track light. Housing: die-cast aluminium, powder-coated, designed as heat sink. and PMMA. optical Lens . UGR <22 Integrated-Type driver.

DUMBER-24W

Max 24W IP20

DIMON
TECHNOLOGY

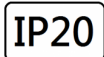
Technical Data

Luminaire Type-安裝方式Tipo de luminaria	Track Mounted Type 軌道燈具 Tipo de huella Montado
Dimension-尺寸-Dimensión	Dia 75 x L 116 mm
QTY of LEDs-燈珠數量-CANT de LEDs	1 pcs CREE LED Array
Input Voltage-輸入電壓-Voltaje de entrada	AC220-240V 50/60HZ
Power Consumption Max-燈具功率 Consumo de energía Max	24W
LED Driver Type LED驅動款式 Tipo de controlador LED	Integrated-type or Remote-type LED Driver--Refer to LED driver specification 請參閱LED驅動器規格 Consulte la especificación de controlador de LED 1. ON/OFF Switch AC220-240V 50/60HZ 2. Dali Dimming Driver AC220-240V 50/60HZ
LED Driver Features驅動特性 Funciones del controlador de LED	POWER FACTOR : PF>0.90 @ Full Load TOTAL HARMONIC DISTORTION: THD< 20%
Beam Angle光束角ángulo de haz	18° 24° 38° 50°
Light Source Brand-光源品牌-Fuente de luz de marca	CREE - (Photobiological safety-IEC 62471 'Risk Group 1' (low risk))
"Lumen Maintenance LM-80 Reported by TM-21"	L70(10k) > 60000 hrs
LED Life-LED壽命-La vida del LED	>60,000 hours
Color Temperature -色溫 Temperatura del color	2700K / 3000K / 4000K / 5000K / 6500K
Color Rendering Index-顯色指數 Índice de reproducción cromática	• >80 • >90
MacAdam Ellipses Binning 麥克亞當橢圓分級 Mac Adam binning elipse	Standard Deviation Colour Matching < 3 SDCM 標準偏差配色 < 3 SDCM Coincidencia de color estándar Desviación < 3 SDCM
Luminaire Efficacy 燈具效率 La eficacia de la luminaria	100 Lm/w(2700K), 110 Lm/w(3000K), 120 Lm/w(4000K), 120 Lm/w(5000K), 120 Lm/w(6500K),
LED Source Luminous Efficacy LED光源光效 Fuente luminosa LED Eficacia	130 Lm/w(2700K), 130 Lm/w(3000K), 140 Lm/w(4000K), 140 Lm/w(5000K), 140 Lm/w(6500K),
Housing materials-外殼材料 Materiales de la carcasa	Die-cast aluminum and acrylic 壓鑄鋁和亞克力 Fundición de aluminio y acrílico
Housing Color 外殼顏色 color de la carcasa	Powder Coating : Matte white / Matte black 粉末塗料: 啞光白色 / 啞光黑色 Recubrimiento en Polvo: Blanco mate / Matte black
Ingress Protection-防護等級 Protección de ingreso	IP20 - (IEC 60529)
Operating Humidity -工作濕度 Humedad de funcionamiento	0~90%, non-condensing-不結霜 sin condensación
Operating Temperature Range / 工作溫度範圍 Rango de temperatura de funcionamiento	-30 °C / +50 °C
Comply Testing Standard 符合測試標準 Cumplir el estándar de prueba	LED Luminaires: IEC 60598-1 / IEC 60598-2-1 LED Driver: EN 55015 / IEC 61000-3-2 / IEC 61347-1 / IEC 61347-2-13 / IEC 61547/ IEC62384
Certification-認證-Certificación	   

Project	Fixture#	Date
		Firm



Ordering Information

Choose the option that suits your need and write its corresponding code on the appropriate line to form the product code.

Example product code: [DUMBER-24W](#)

DUMBER-24W - 24W
[Power Consumption](#)

Power Consumption	
Code	Description
24W	24W

BEAM ANGLE

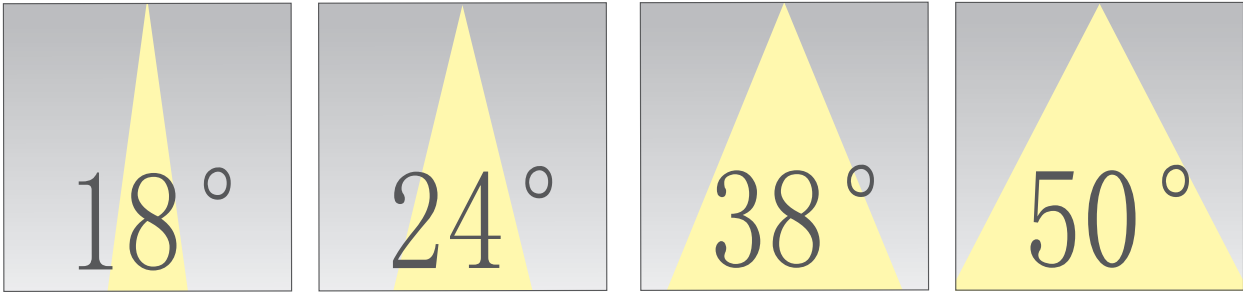

Technical Drawing

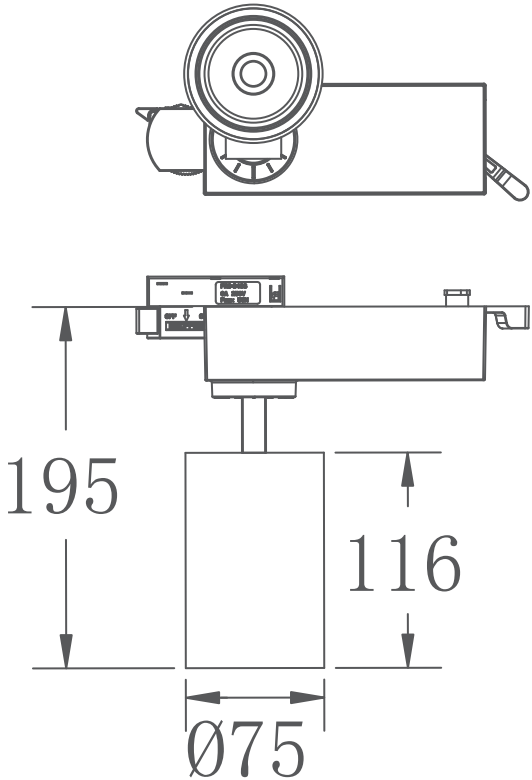

Track Connector



Single-phase 2-phase 3-phase

Track light driver box optional

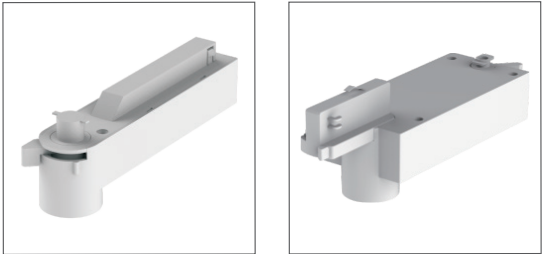

PC-BOX-LR1003 PC-BOX-DALI

Unit: mm