

HANNAH@FENCE 78

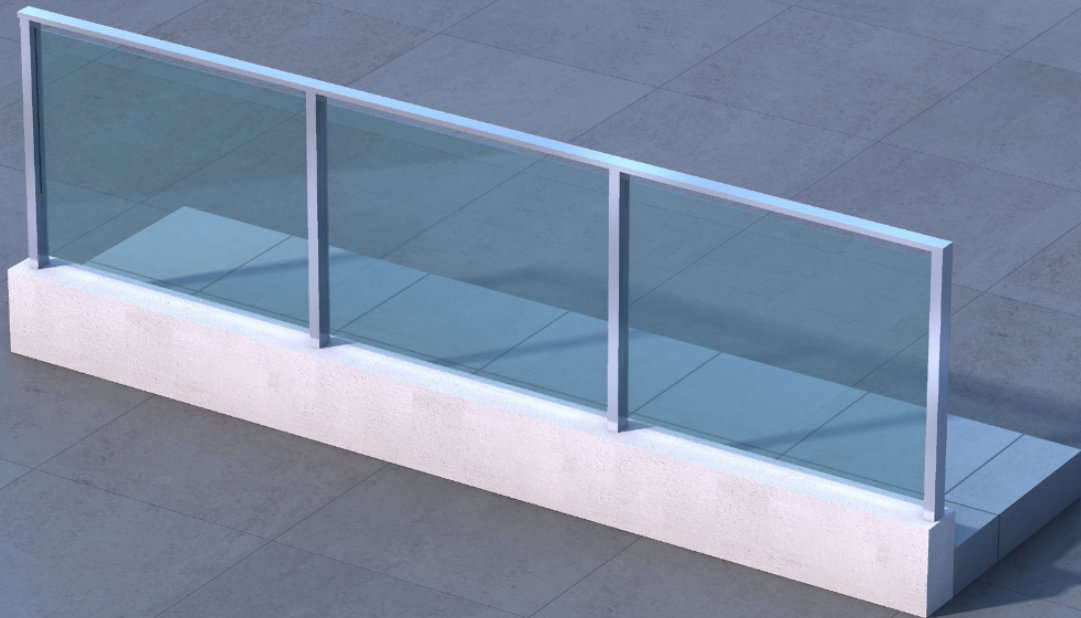

Balcony or Podium platform Application



- Balcony or Podium platform Application
- 10mm Clear Laminated Tempered Glass
- Stainless Steel Grade S316L 80 x 25 PLATE
- 70*80*3mm Aluminum Cover
- Welding comply BS EN 1011-1; BS EN 1011-2; BS EN ISO 15614
- Stainless Steel Fasteners A4-70 comply with BS EN ISO 3506-1.

Technical Data

Major Material:

- Stainless Steel Grade S316L with ASTM A511 and Plate with ASTM A240
- Welding comply BS EN 1011-1; BS EN 1011-2; BS EN ISO 15614
- Stainless Steel Fasteners A4-70 comply with BS EN ISO 3506-1.
- M10.S.S A4-70 Bolt & Nut
- 10mm Laminated Tempered Glass

Finishes

Hairline Finish for Stainless Steel Grade S316L

Tempered Glass color

- Clear
- Dark Grey,
- Euro grey;
- Ocean blue,
- Ford blue,
- Dark blue

Certification



Project	Fixture#	Date
		Firm



Ordering Information

Choose the option that suits your need and write its corresponding code on the appropriate line to form the product code.

Example product code:

HANNAH@FENCE-78 -

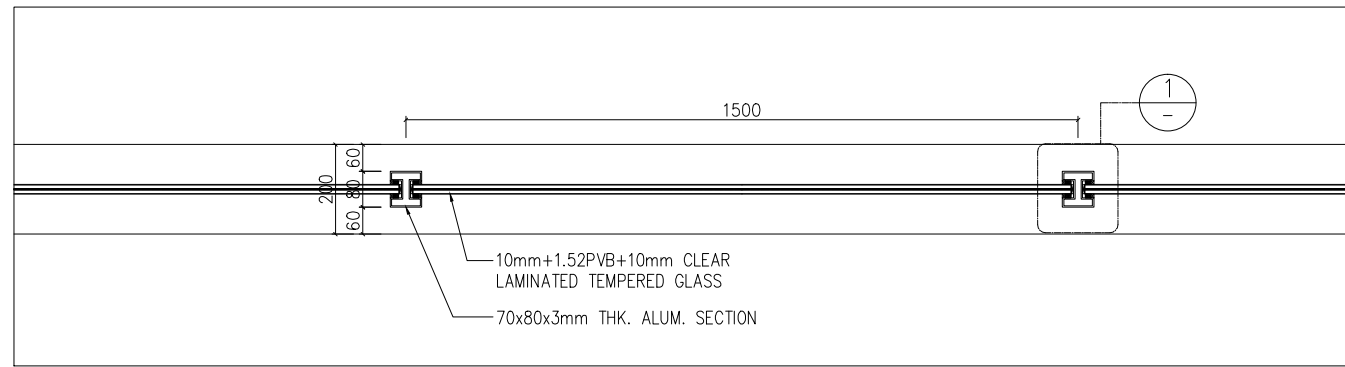

2 HANNAH@FENCE 78 TYPICAL PLAN
SCALE 1:8

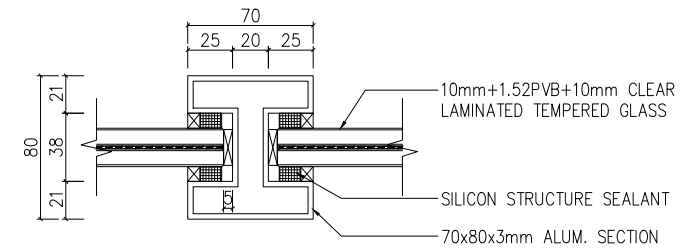
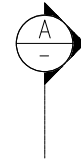

1 DETAIL
SCALE 1:2

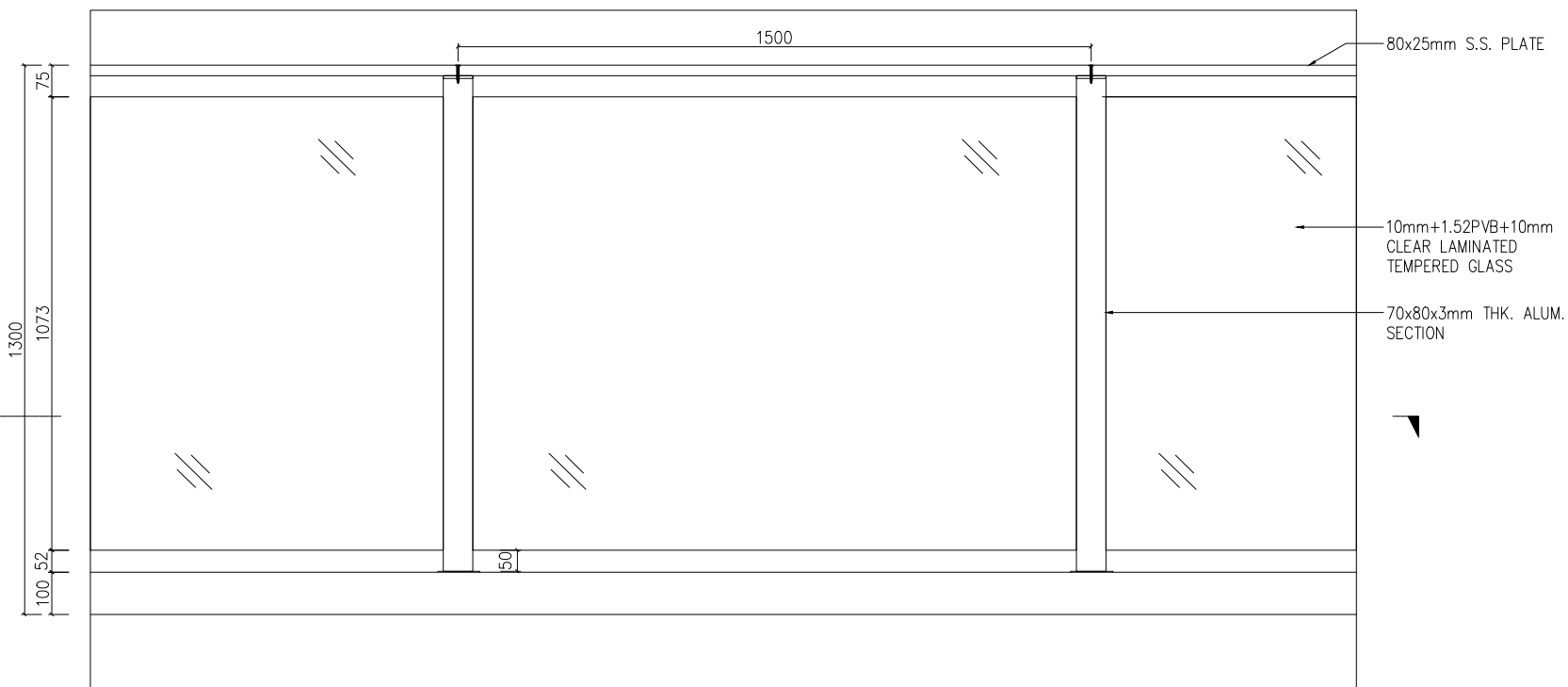

1 HANNAH@FENCE 78 TYPICAL ELEVATION
SCALE 1:8

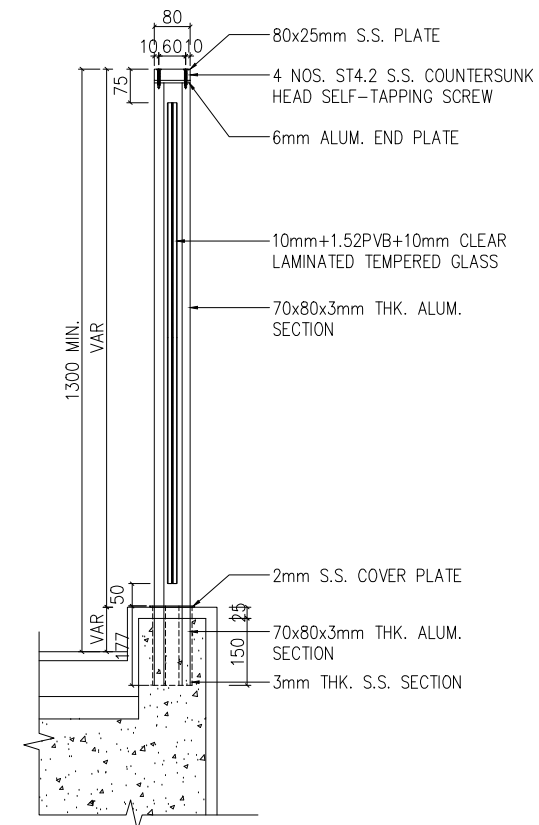

Drawing Status :

Ref NO.:

Client

Management :

Supplier :

DIMON
Technology

DIMON Technology Ltd.

Tel: 00852-3916 5876

Fax: 00852-21203398

Http://www.dimontechnology.com

E-mail:gary@dimontechnology.com

Project:

Job Title:

HANNAH@FENCE 78

Drawing Name:

RAILING
ELEVATION , PLAN AND DETAILS

Drawing NO.: RL-007

Drawing Scale: AS SHOW

Drawing Date: 2021/01/31

Drawing: Cai

Collate: Joyi

Auditing: Gray Hui

Drawing Version: 1