







LYNEE

RGBW W:41xH:55mm 10W Max IP65



LED COLOR LINEAR is a indoor and outdoor fixture with RGBW color for media façade application. It is able to be controlled by DMX and RDM. Built-in 16-bit PWM embedded LED IC, featuring 16-bit gray scale control, supports up to 65,536 gray scales for color depths. The high visual refresh rate can facilitate CCD cameras and video cameras to capture the full video images in real time without flickers.

Technical Data

Luminaire Type/ 安裝方式 Tipo de luminaria	Surface Mounted Type 明裝式燈具 Superficie Tipo Montado
Color -顏色-Color	RGBO (Orange White: 2700K) RGBW (Warm White: 3000K) RGBN(Nature White: 4000K) RGBD (Day White: 5000K) RGBC (Cool White: 6500K)
Power Consumption Max 燈具最大功率 Consumo de energía Max	<ul style="list-style-type: none"> • 5W @ L: 500mm • 10W @ L: 1000mm • Tailor-made - 客制生產-Hecho a medida
Pixels & DMX Channels 像素和DMX 通道 Píxeles y canales DMX	<ul style="list-style-type: none"> • 5 PXL =20 DMX Channels @ 5W(500mm) • 10 PXL= 40 DMX Channels @ 10W (1000mm) • 1 PXL =4 DMX Channels @ 5W(500mm) • 1 PXL= 4 DMX Channels @ 10W (1000mm) • Tailor-made - 客制生產-Hecho a medida
Control Protocol-控制協議 Protocolo de Control	DMX 512A / RDM
Input Voltage / 輸入電壓 Voltaje de entrada	DC24V
Color Range 顏色範圍 Gama de colores	16.7 Million additive RGB colors and White LED 1670萬RGB顏色配合白光LED 16.7 Millones de colores aditivos RGB; LED blanco
RGBW Color Resolution with Gamma correction RGBW顏色經過伽馬校正的分辨率 Resolución de color RGB W con la corrección de gamma	4 x 16-bit gray scale control and Gamma correction, supports up to 65,536 gray scales for color depths 4 x 16位灰度控制，支持高達65,536個灰度級的顏色深度 4 x control de escala de grises de 16 bits, soporta hasta 65.536 escalas de gris para profundidades de color
Beam Angle/光束角 ángulo de haz	110°
Light Source Brand/光源品牌 Fuente de luz de marca	OSRAM - (Photobiological safety-IEC 62471 'Risk Group 1' (low risk))
LED Life/LED壽命 La vida del LED	>50,000 hours
MacAdam Ellipses Binning 麥克亞當橢圓分級 Mac Adam binning elipse	Standard Deviation Colour Matching < 2 SDCM 標準偏差配色 < 2 SDCM Coincidencia de color estándar Desviación < 2 SDCM
Luminaire Efficacy-燈具效率 La eficacia de la luminaria	<ul style="list-style-type: none"> • 40 Lm/w(RGBO@Full Load) • 40 Lm/w(RGBW@Full Load) • 50 Lm/w(RGBN@Full Load) • 55 Lm/w(RGBD@Full Load) • 55 Lm/w(RGBC@Full Load)
LED Source Luminous Efficacy-LED光源光效 Fuente luminosa LED Eficacia	<ul style="list-style-type: none"> • 50 Lm/w(RGBO@Full Load) • 50 Lm/w(RGBW@Full Load) • 60 Lm/w(RGBN@Full Load) • 70 Lm/w(RGBD@Full Load) • 70 Lm/w(RGBC@Full Load)
Housing materials/外殼材料 Materiales de la carcasa	Aluminium Alloy and Milky Polycarbonate Diffuser 鋁合金和乳白PC罩 Aleación de aluminio y difusor de policarbonato lechoso
Trim Housing Color/ 邊框殼顏色	Anodised Aluminium Titanium and Milky Diffuser /陽極氧化鋁鈦和乳白罩 Aluminio anodizado titanio y Vía Difusor Anodised Aluminium Black and Milky Diffuser /陽極氧化鋁黑和乳白罩 Aluminio anodizado Negro y Vía Difusor Tailor-made/客制生產-Hecho a medida
Operating Temperature Range / 工作溫度範圍 Rango de temperatura de funcionamiento	-20 °C / +60 °C
Operating Humidity -工作濕度 Humedad de funcionamiento	0~90%, non-condensing-不結霜 sin condensación
Ingress Protection/ 防護等級 Protección de ingreso	IP65 - (IEC 60529)
Dimension/尺寸 Dimensión	<ul style="list-style-type: none"> • W41 x H55 x L500 mm • W41 x H55 x L1000 mm
Environment/ 使用環境 Medio ambiente	Outdoor /戶外/al aire libre
Comply Testing Standard 符合測試標準 Cumplir el estándar de prueba	LED Luminaires: IEC 60598-1 / IEC 60598-2-3 / Photometric data-IES format LED Driver: EN 55015 / IEC 61000-3-2 / IEC 61347-1 / IEC 61347-2-13 6 / IEC 61547
Certification-認證-Certificación	      

Project	Fixture#	Date
		Firm

Ordering Information

Choose the option that suits your need and write its corresponding code on the appropriate line to form the product code.

Example product code: [LYNEE-10W-RGBN-10P-AT-DMX](#)

LYNEE - - - - -

Power Consumption
Color Temperture
PIXELS
House Color
Control Type

Power Consumption		Color Temperture		PIXELS		House Color		Control Type	
Code	Description	Code	Description	Code	Description	Code	Description	Code	Description
5W	5W@L:500mm	RGBO	RGBO(2700K)	1P	1 Pixel / Meter	AB	Anodised Aluminium Black	DMX	DMX
10W	10W@L:1000mm	RGBW	RGBW(3000K)	10P	10 Pixels / Meter	AT	Anodised Aluminium Titanium	RDM	RDM
XXW	Tailor-Made	RGBN	RGBN(4000K)	TP	Tailor-Made				
		RGBD	RGBD(5000K)						
		RGBC	RGBC(6500K)						

Accessories



MANYA



SLADE



CORE-DMX SPLITTER



HLG-120H

Technical Drawing

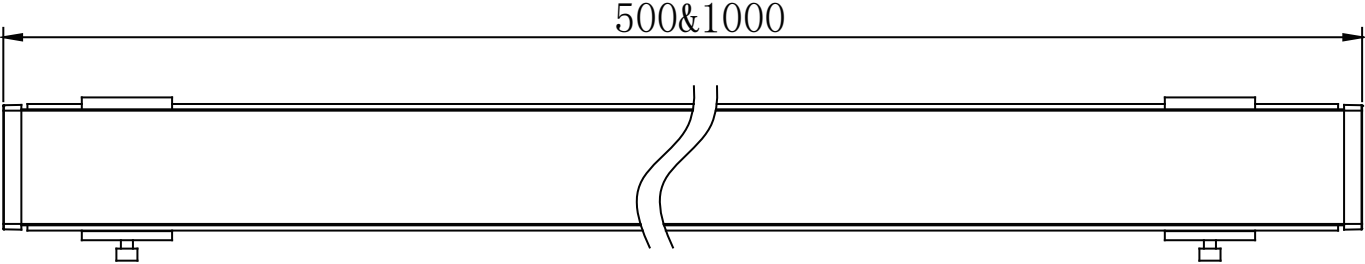
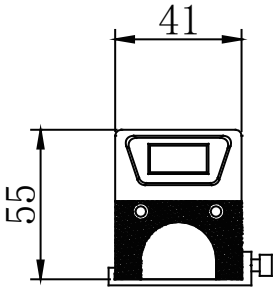

Unit: mm